

Front Brake Squeak (2WD)

Service Category Brake

Section Brake (front)

Market USA

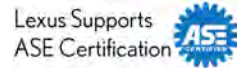

Applicability

YEAR(S)	MODEL(S)	ADDITIONAL INFORMATION
2007 – 2008	GS350, GS450H	VDS(s): BC96S, BE96S
2006 – 2007	GS430	VDS(s): BN96S
2008	GS460	VDS(s): BL96S
2006 – 2009	IS350	VDS(s): BE262

TSIB REVISION NOTICE

April 20, 2009 Rev1:

- The GS 350 AWD model has been removed from this TSIB's applicability. This TSIB does not apply to this model.
- The note in step 4, Repair Procedure section has been updated.

Any previous printed versions of this service bulletin should be discarded.

Introduction

Some Lexus customers may experience a squeal or squeak noise in cold weather conditions from the front of the vehicle when lightly applying the brakes. A new anti-squeal shim kit has been made available to address this concern. Use the following repair procedure to address customer concerns.

Front Brake Squeak (2WD)

Production Change Information

This TSIB applies to vehicles produced **BEFORE** the Production Change Effective VINs shown below.

MODEL	DRIVETRAIN	PRODUCTION CHANGE EFFECTIVE VIN
GS 350	2WD	JTHBE96S#80042708
GS 450h		JTHBC96S#85017446
GS 430*		-
GS 460		JTHBL96S#85002912
IS 350		JTHBE262#95022078
		JTHBG262#92016325

* This TSIB applies to ALL 2006 – 2007 model year GS 430 vehicles.

Warranty Information

OP CODE	DESCRIPTION	MODEL	MODEL YEAR	TIME	OPF	T1	T2
473301	R & R Front Disc Brake Pads and/or Shims	GS 350	2007–2008	0.7	04945-22151	36	83
		GS 450h					
		GS 430	2006–2007				
		GS 460	2008				
		IS 350	2006–2009	0.6			

APPLICABLE WARRANTY

- This repair is covered under the Lexus Comprehensive Warranty. This warranty is in effect for 48 months or 50,000 miles, whichever occurs first, from the vehicle's in-service date.
- Warranty application is limited to correction of a problem based upon a customer's specific complaint.

Parts Information

PREVIOUS PART NUMBER	CURRENT PART NUMBER	PART NAME	QTY
04945-22151	04945-22152	Shim Kit, Anti Squeal, Front	1
04465-30410	Same	Pad Kit, Disc Brake, Front*	1

* Refer to Repair Procedure to determine if high performance brake pads need replacing.

Repair Procedure

1. Conduct a road test to verify the noise condition. Noise usually occurs during stops with light pressure applied to the brake pedal.

Front Brake Squeak (2WD)

Repair Procedure (Continued)

NOTE

This procedure is for the right-hand side. Perform the same procedure for the left-hand side.

2. Remove the front wheel.
3. Determine if the vehicle is equipped with high performance or alternative brake pads as per TSIB [L-SB-0121-08](#), "Alternative Front Brake Pads".
 - High performance brake pads (P/N 04465-30410) are black in color.
If vehicle is equipped with high performance brake pads, go to step 4 to determine if pad orientation is correct.
 - Alternative brake pads (P/N 04465-30400) are green in color.
If vehicle is equipped with alternative brake pads, go to step 5.
4. For high performance brake pads ONLY, refer to Figure 1 to determine if pad orientation is correct.

Figure 1. Example of Correct Orientation for High Performance Brake Pads

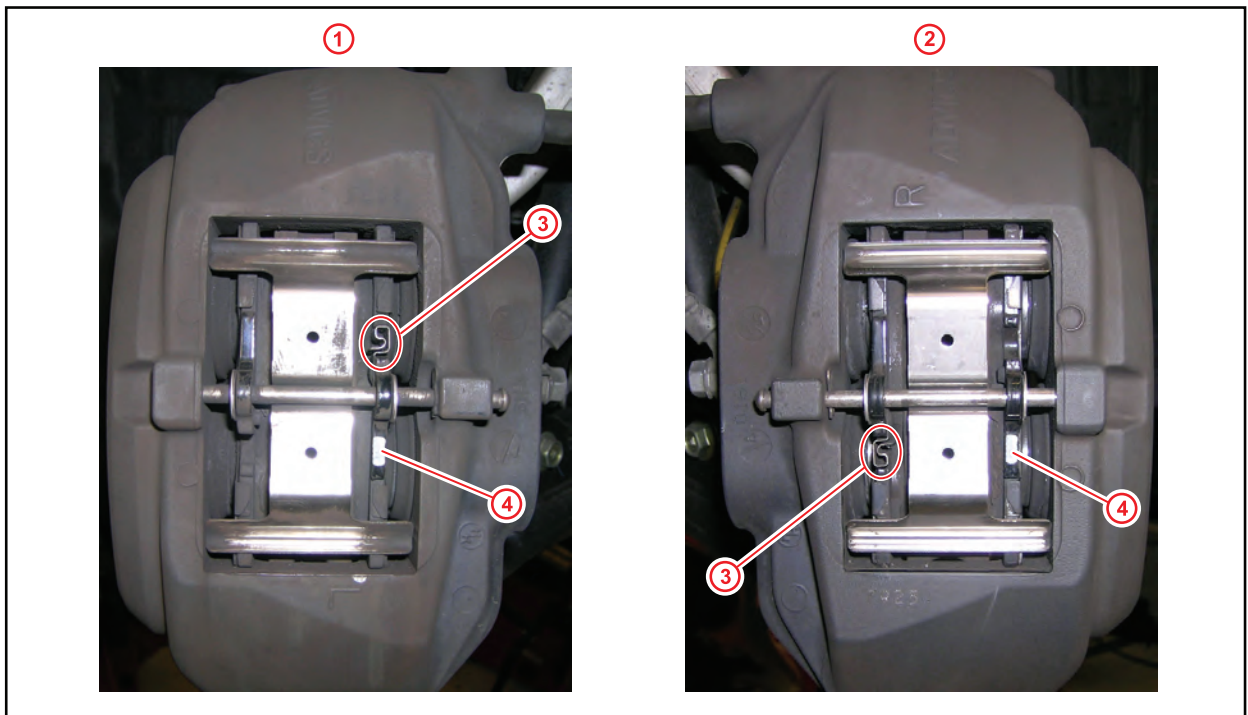

1	Left Front Caliper
2	Right Front Caliper

3	Wear Indicators
4	Identification Paint Marks

Front Brake Squeak (2WD)

Repair Procedure (Continued)

NOTE

If the high performance brake pad identification marks are worn off and not visible, refer to Figure 5 in this TSIB to determine pad orientation.

- If pad orientation is correct, go to step 5.
 - If pad orientation is *incorrect*, DISCARD the existing pads and replace with NEW high performance brake pads according to the repair procedure starting at step 5.
5. Remove the anti-rattle spring, hole pin, and clip.
 6. Remove the front brake pads with the anti-squeal shims from the caliper assembly.
 7. Discard the original No. 1 and No. 2 shims.
 8. Use a clean shop rag to remove ALL grease off the backside of the brake pads.
 9. Install the NEW No. 1 and No. 2 anti-squeal shims on the brake pads. Do NOT apply any grease to the pads or shims.

Figure 2.

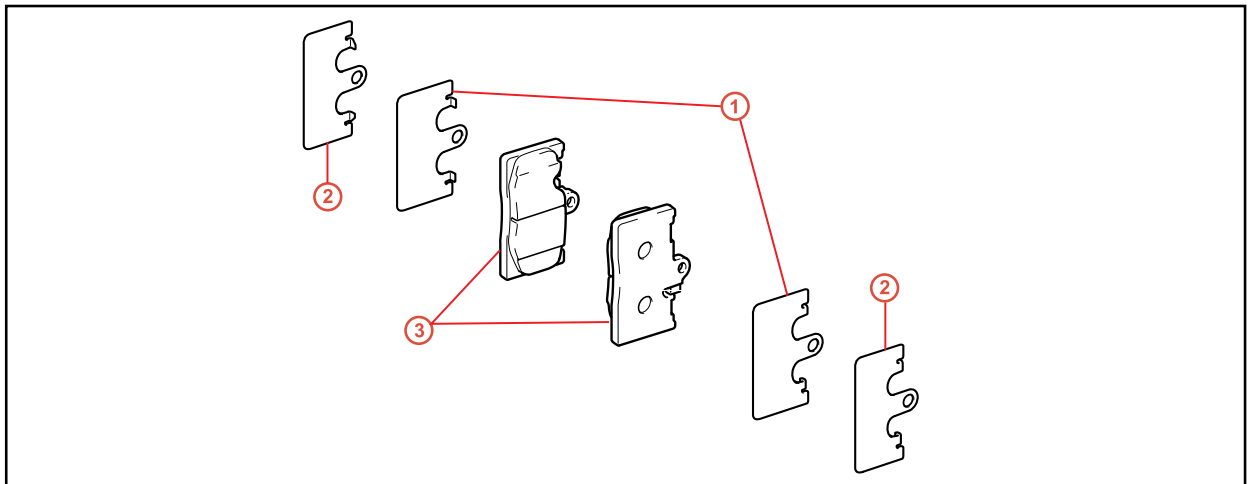

1	No. 1 Anti-squeal Shim
2	No. 2 Anti-squeal Shim

3	Disc Brake Pad
----------	-----------------------

- A. Install the No. 1 anti-squeal shims (112 mm wide) with the coated side toward the backside of the brake pads.
- B. Install the No. 2 anti-squeal shim (117 mm wide) onto the No. 1 anti-squeal shim with the coated side away from the brake pad.

Front Brake Squeak (2WD)

Repair Procedure (Continued)

Figure 3.

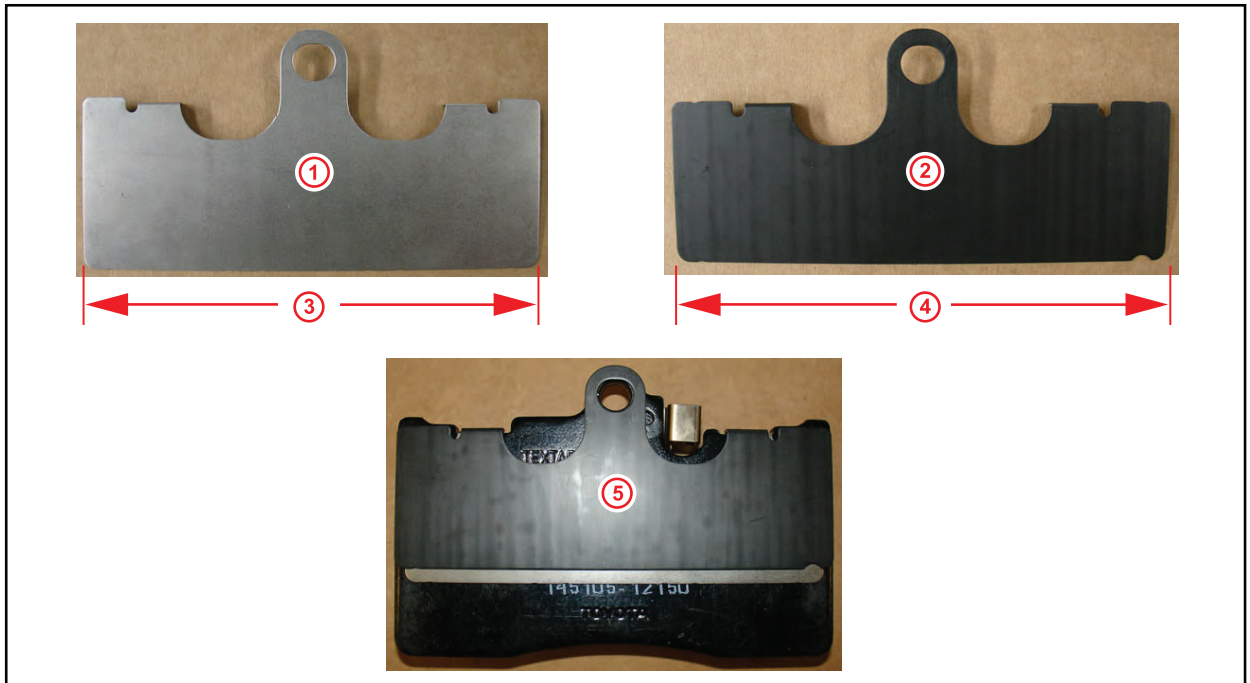

1	New No. 1 Anti-squeal Shim
2	New No. 2 Anti-squeal Shim
3	112 mm (4.41 in.)

4	117 mm (4.61 in.)
5	Brake Pad with No. 1 and No. 2 Shims

- Center the No. 1 and No. 2 anti-squeal shim locating tabs in the brake pad guides.

Figure 4.

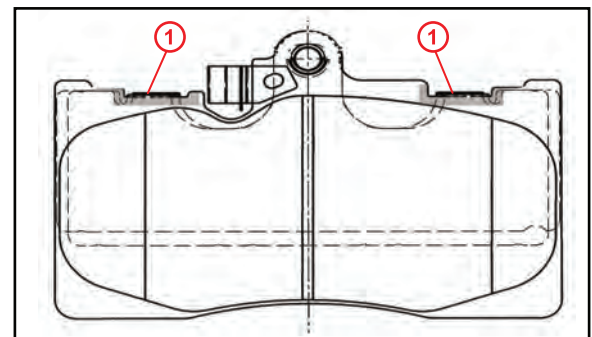

1	Upper Locating Tabs
---	---------------------

Front Brake Squeak (2WD)

Repair Procedure (Continued)

11. Install the inner and outer original brake pads with the NEW anti-squeal shims into the caliper assembly according to the following table.

NOTE

- Because of the different sized leading and trailing chamfers, each pad **MUST** be installed in a specific location.
- Ensure the pads with the wear indicators are installed on the inboard side of the calipers.

Figure 5.

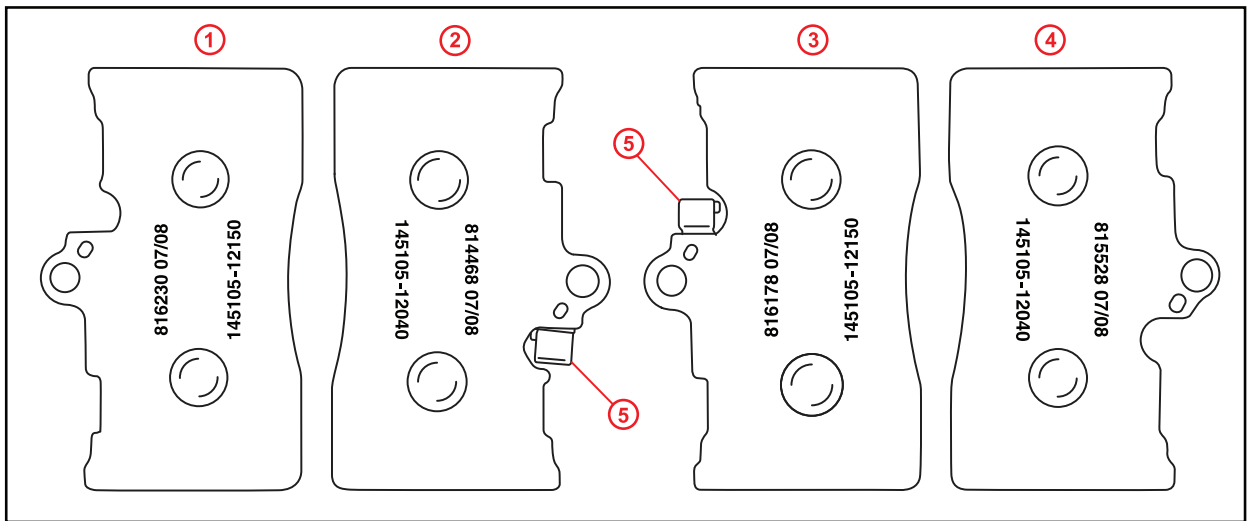

	PART NUMBER	WEAR INDICATOR (5)	LOCATION
1	145105-12150	No	Left Outboard
2	145105-12040	Yes	Left Inboard
3	145105-12150	Yes	Right Inboard
4	145105-12040	No	Right Outboard

12. Install the anti-rattle spring, hole pin, and clip.

Front Brake Squeak (2WD)

Repair Procedure (Continued)

13. Ensure the shim locating tabs are properly centered on the brake pad guides.

Figure 6.

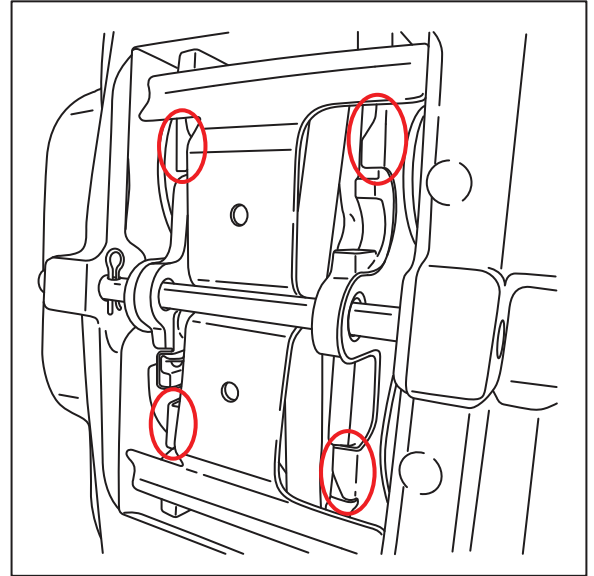

14. Complete the repair by installing wheels and torque wheel nuts.
Torque: 103 N*m (1050 kgf*cm, 76 ft*lbf)
15. Road test the vehicle to confirm the front brake squeak is NO longer present.