



Applies To: **2003 Accord L4 A/T – ALL**

**May 4, 2004**

**2004 Accord L4 A/T 2-door** – From VIN 1HGCM7...4A000001 thru 1HGCM7...4A009608

**2004 Accord L4 A/T 4-door** – From VIN 1HGCM5...4A000001 thru 1HGCM5...4A057899

– From VIN 3HGCM5...4G700001 thru 3HGCM5...4G703063

– From VIN JHMCM5...4C000001 thru JHMCM5...4C028489

## Engine Vibrates While Idling In Gear

### SYMPTOM

Excessive vibration is felt in the seat and steering wheel when the transmission is put in Drive or Reverse. The vibration may be worse in cold weather or with loads, such as with the A/C on or when the steering wheel is turned.

### PROBABLE CAUSE

Not enough engine dampening.

### CORRECTIVE ACTION

Based on the VIN, do either REPAIR PROCEDURE A or REPAIR PROCEDURE B.

#### REPAIR PROCEDURE A:

Replace the front engine mount. Loosen and then torque all engine mounting bolts.

#### REPAIR PROCEDURE B:

Replace the front engine mount, loosen and then torque all engine mounting bolts, and install the engine idle smoothing kit.

### PARTS INFORMATION

Front Engine Mount:

P/N 50830-SDA-A04, H/C 7622301

Engine Idle Smoothing Kit:

P/N 50830-SDA-999, H/C 7637044

(Kit contains 4 bolts, 2 lower radiator mounts, 2 upper radiator mount washers, and 1 front bumper mass.)

### WARRANTY CLAIM INFORMATION

**In warranty:** The normal warranty applies.

OP#	Description	FRT
112118	Install the front engine mount, and loosen and torque all engine mounting bolts (REPAIR PROCEDURE A)	0.7
112119	Install the front engine mount, loosen and torque all engine mounting bolts, install the engine idle smoothing kit. (REPAIR PROCEDURE B)	1.1

Failed Part: P/N 50830-SDA-A02  
H/C 7138902

Defect Code: 09999

Symptom Code: 04505

Skill Level: Repair Technician

**Out of warranty:** Any repair performed after warranty expiration may be eligible for goodwill consideration by the District Parts and Service Manager or your Zone Office. You must request consideration, and get a decision, before starting work.

### REPAIR PROCEDURE A

**2004 Accord 2-door from VIN 1HGCM7...4A000022 thru 1HGCM7...4A009608**

**2004 Accord 4-door from VIN 1HGCM5...4A000085 thru 1HGCM5...4A057899**

**2004 Accord 4-door from VIN 3HGCM5...4G700003 thru 3HGCM5...4G703063**

**2004 Accord 4-door from VIN JHMCM5...4C000038 thru JHMCM5...4C028489**

1. Remove the vacuum hose from the vacuum line that is next to the front engine mount.

- Remove the front mount stop mounting nuts, the front mount stop, and the vacuum hose clamp bracket. Then remove the front mount bolt, and the four lower mounting bolts.

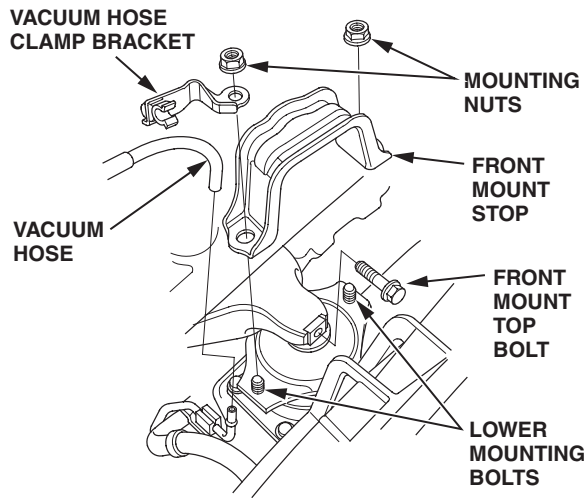

- Place a floor jack with a block of wood under the transmission, and raise the engine up enough to remove the front engine mount.
- Install the new front engine mount, and torque the four lower bolts to 54 N·m (40 lb-ft). Install the front mount stop and the vacuum hose clamp bracket, and torque the nuts to 78 N·m (58 lb-ft). Install the front mount bolt, but leave it loose at this time.
- Inspect the rear engine mount for tears, and replace it if necessary.
- With the vehicle on a lift, inspect the rubber exhaust mount for tears, and replace it if necessary.

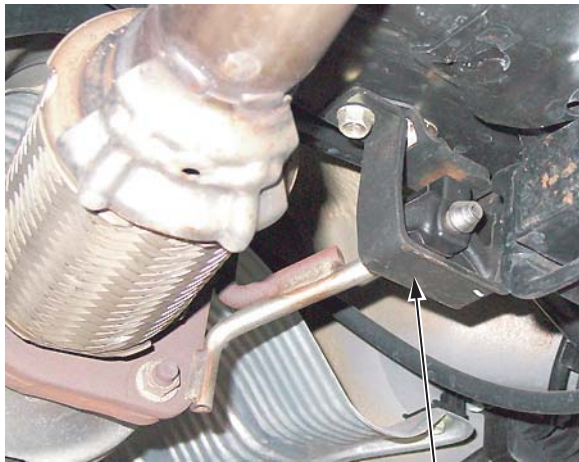

RUBBER EXHAUST MOUNT

- Loosen all of the engine mount bolts; start the engine, and let it idle. With your foot on the brake pedal, rock the engine by shifting the transmission between drive and reverse several times.
- Shift to park and shut off the engine. Torque all engine mount bolts to the specified torque value. (See page 5-10 of the 2003–04 Accord Service Manual.)

## REPAIR PROCEDURE B

2003 Accord – L4 ALL

2004 Accord 2-door from VIN 1HGCM7...4A000001  
thru 1HGCM7...4A000021

2004 Accord 4-door from VIN 1HGCM5...4A000001  
thru 1HGCM5...4A000084

2004 Accord 4-door from VIN 3HGCM5...4G700001  
thru 3HGCM5...4G700002

2004 Accord 4-door from VIN JHMCM5...4C000001  
thru JHMCM5...4C000037

- Remove the vacuum hose from the vacuum line that is next to the front engine mount.
- Remove the front mount stop mounting nuts, the front mount stop, and the vacuum hose clamp bracket. Then remove the front mount bolt, and the four lower mounting bolts.

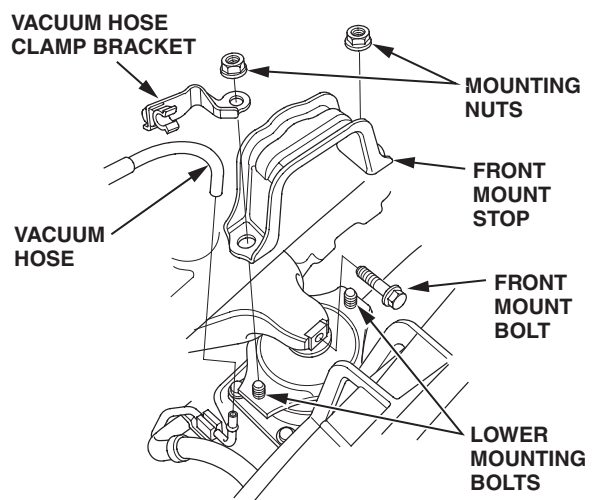

- Place a floor jack with a block of wood under the transmission, and raise the engine up enough to remove the front engine mount.
- Install the new front engine mount, and torque the four lower bolts to 54 N·m (40 lb-ft). Install the front mount stop and the vacuum hose clamp bracket, and torque the nuts to 78 N·m (58 lb-ft). Install the front mount bolt, but leave it loose at this time.
- Inspect the rear engine mount for tears, and replace it if necessary.

- With the vehicle on a lift, inspect the rubber exhaust mount, and replace it if necessary.

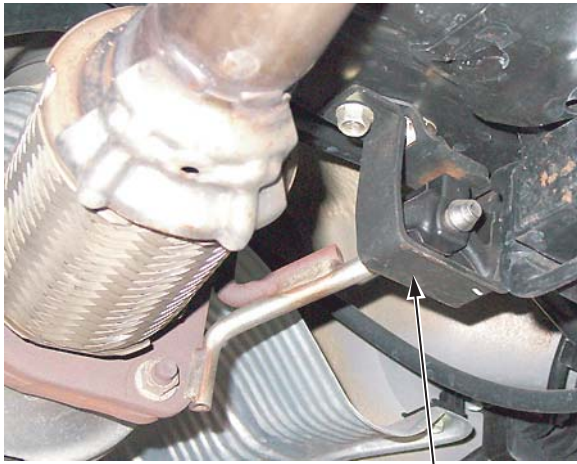

RUBBER EXHAUST MOUNT

- Loosen all of the engine mount bolts; start the engine, and let it idle. With your foot on the brake pedal, rock the engine by shifting the transmission between drive and reverse several times.
- Shift to Park, and shut off the engine. Torque all engine mount bolts to the specified torque value. (See page 5-10 of the 2003–04 Accord Service Manual.)
- Remove the original front bumper mass through the bumper opening. Install the new heavier bumper mass with the bolts supplied in the engine idle smoothing kit. Take care not to damage the A/C condenser.

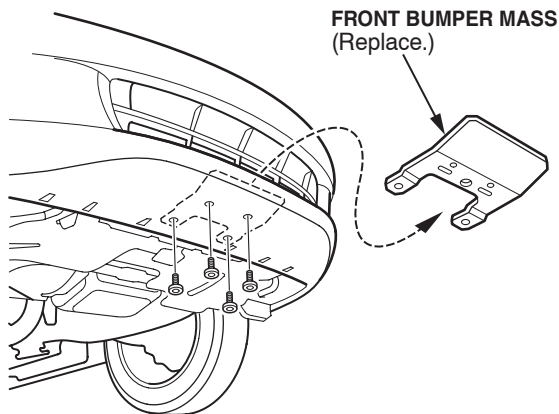

- Remove the front bulkhead cover and the top radiator retaining brackets. Without draining the coolant, lift the radiator up carefully, and replace the existing lower rubber mounts with the new rubber mounts from the kit. Make sure the radiator is fully seated into the new lower mounts.

NOTE: There should be a small gap between the top of the radiator and the rubber grommet on the retaining brackets. If there is no gap, make sure that the lower rubber mounts are fully seated into the body.

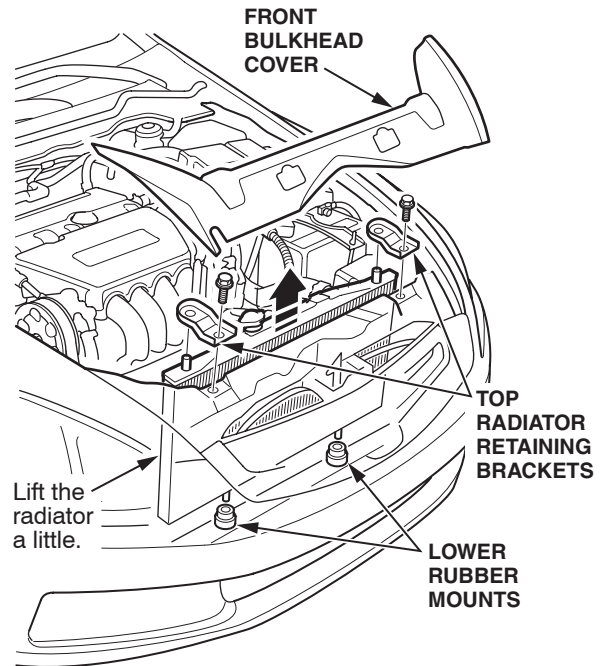

- Install one washer from the kit on each side between the bulkhead and the radiator retaining brackets. Torque the bolts to 12 N·m (8.7 lb-ft).

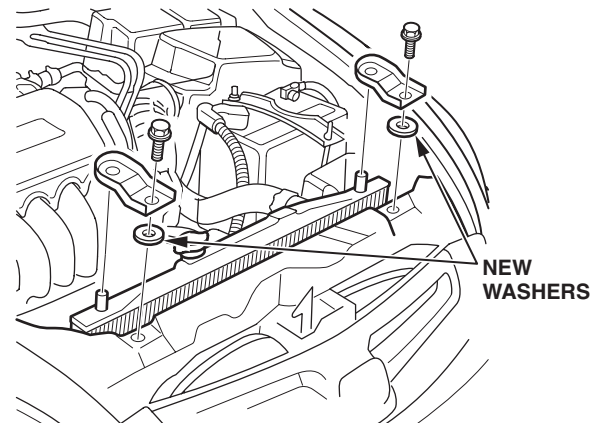

- Reinstall the bulkhead cover.

13. Check the year of the vehicle.

- If the vehicle is a 2004 model, the repair is complete.
- If the vehicle is a 2003 model, go to step 14.

14. Refer to Service Bulletin 03-042, *Product Update: No-Reverse Condition*. This service bulletin has software changes that will help with engine idle vibration at cold start up.

- If the vehicle is outside the VIN ranges shown in service bulletin 03-042, the repair is complete.
- If the vehicle is within the VIN ranges shown in service bulletin 03-042, check for a center-punched completion mark above the ninth character of the engine compartment VIN. If the campaign has been completed, the repair is complete.
- If the vehicle is within the VIN ranges shown and the campaign has not been completed, update the PCM according to Service Bulletin 03-042, *Product Update: No-Reverse Condition*.