

© 2007 Mazda Motor of America, Inc.

Subject: UNUSUAL NOISE FROM STEERING SHAFT WHEN TURNING STEERING WHEEL	Bulletin No: 06-001/07
	Last Issued: 02/22/2007

APPLICABLE MODEL(S)/VINS

2003 - 2007 Mazda6

DESCRIPTION

On some vehicles, the steering shaft may make an unusual clunk noise during acceleration while the steering wheel is turned. The intermediate shaft splines in the steering column may be lacking lubrication and causing the clunk noise.

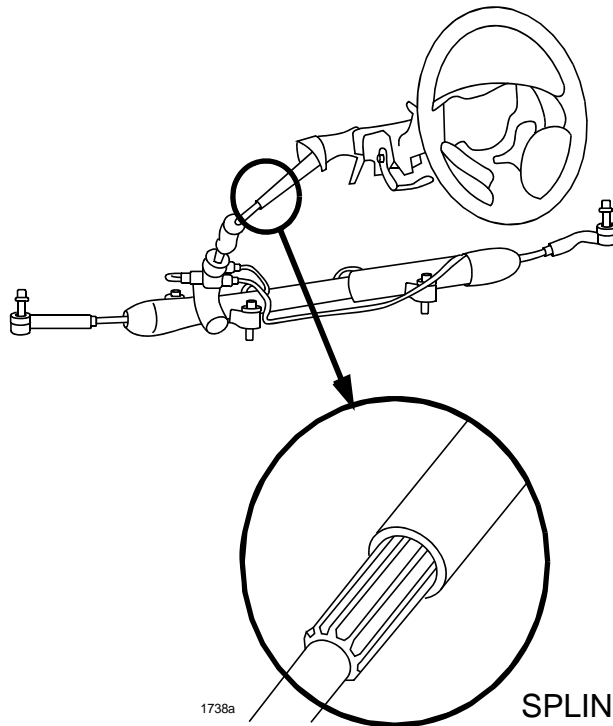

Customers having this concern should have their vehicle repaired using the following repair procedure.

CONSUMER NOTICE: The information and instructions in this bulletin are intended for use by skilled technicians. Mazda technicians utilize the proper tools/equipment and take training to correctly and safely maintain Mazda vehicles. These instructions should not be performed by "do-it-yourselfers." Customers should not assume this bulletin applies to their vehicle or that their vehicle will develop the described concern. To determine if the information applies, customers should contact their nearest authorized Mazda dealership. Mazda North American Operations reserves the right to alter the specifications and contents of this bulletin without obligation or advance notice. All rights reserved. No part of this bulletin may be reproduced in any form or by any means, electronic or mechanical---including photocopying and recording and the use of any kind of information storage and retrieval system ---without permission in writing.

REPAIR PROCEDURE

NOTE: Before performing this repair procedure, be sure to inform the customer that the new super grease is very effective for noise, but it may change the steering and handling feel of their vehicle. Also, the operation of the telescopic steering (if equipped) may feel slightly heavier after the repair.

1. Verify customer concern by changing steering column angle and length (telescoping only), then attempt to duplicate clunk noise.

WARNING: Do not attempt to adjust the steering column angle or length while driving the vehicle. Be sure to adjust the steering wheel only when the vehicle is stopped as you can lose control of the vehicle if you change the steering tilt or position while driving.

2. Repeat Step 1 two (2) more times using different steering column angles and lengths (telescoping only), then attempt to duplicate clunk noise.
 - If clunk noise is gone, proceed to Step 3.
 - If clunk noise is still present, do not proceed with this repair procedure. Troubleshoot other causes of noise according to related sections of the Workshop Manual.
3. For telescopic equipped vehicle: Position steering shaft to most forward position.
4. Remove two (2) push-nuts securing joint cover.
5. Remove joint cover.
6. Remove pinch-bolt securing intermediate shaft.

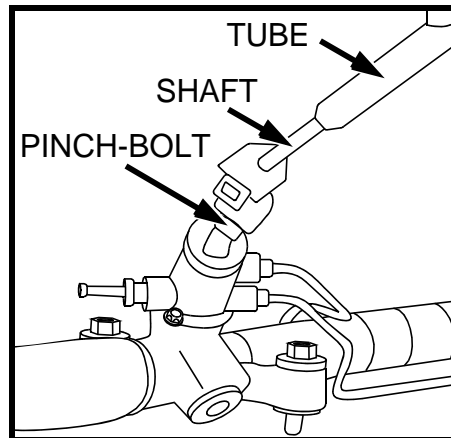
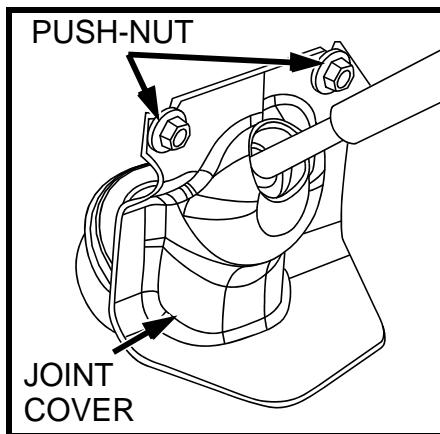

7. Slide shaft toward A to remove from steering gear.

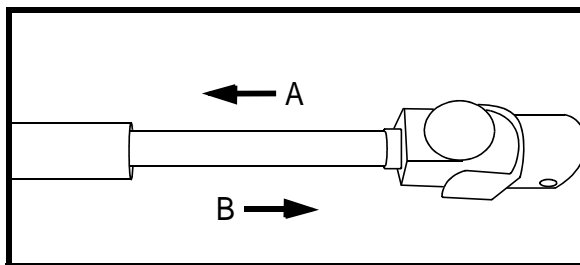

8. Slide shaft toward B to remove from tube.

9. Wipe all grease off splines.

REMOVE GREASE FROM SPLINES

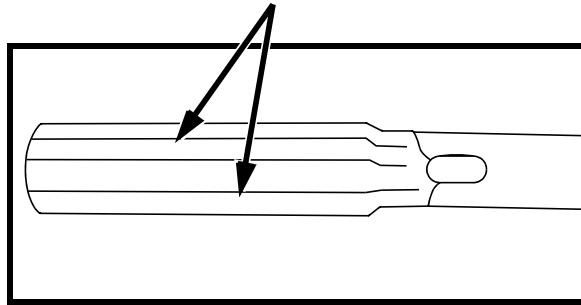

1738e

10. Apply approx. 5 cc of new super grease to splines and inside the tube.

APPLY NEW GREASE TO
SPLINES AND TUBE

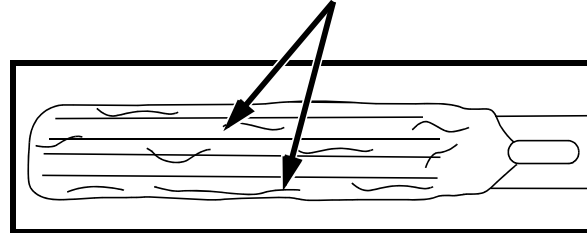

11. Align marks and assemble tube and shaft.

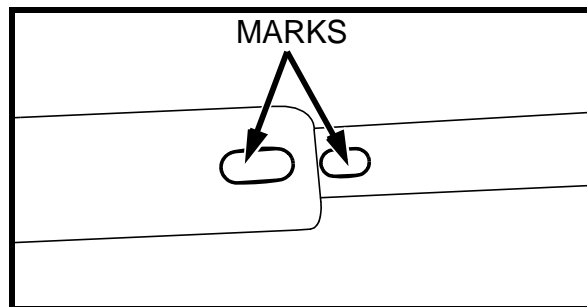

1738g

12. Wipe off any extra grease.
13. Fit intermediate shaft to steering gear and tighten pinch bolt.
Tightening torque: 13.8 - 19.5 ft-lbf. (18.8 – 26.5 Nm, 1.9 - 2.7 kgfm)
14. Fit joint cover and reinstall two (2) push-nuts.
15. After reassembly, operate telescopic or tilt steering as follows:
- For vehicles equipped with tilt and telescopic: Operate telescopic three (3) times from front to rear. Operate tilt three (3) times from top to bottom, then return to original position.
 - For vehicles equipped with tilt only: Operate tilt three (3) times from top to bottom, then return to original position.
16. Verify repair.

Bulletin No: 06-001/07
© 2007 Mazda Motor of America, Inc.

Last Issued: 02/22/2007

PART(S) INFORMATION

Part Number	Description	Qty.	Notes
0000-77-230E-01	Super Grease	1	1 oz. tube will repair 2 - 3 vehicles

WARRANTY INFORMATION

NOTE:

- This warranty information applies only to verified customer complaints on vehicles eligible for warranty repair. Refer to the Warranty Wizard for warranty term information.
- Additional diagnostic time cannot be claimed for this repair.

Warranty Type	A
Symptom Code	82
Damage Code	91
Part Number Main Cause	5555-07-008A
Quantity	0
Operation Number / Labor Hours:	XXC024RX / 0.4 (includes cost of grease)